

HIKOKI

CIRCULAR SAW C6MEY

| Item No. | Code No. | Description | No. Used | Remarks |
|----------|----------|--|----------|--|
| 1 | 329975 | WASHER (A) | 1 | |
| 2A | 370007 | BEARING HOLDER ASS'Y | 1 | INCLUD. 6A-8,14-17 |
| 3 | 940079 | RETAINING RING FOR D8 SHAFT | 1 | |
| 4 | 339378 | COUPLING COVER | 1 | |
| 5 | 339377 | COUPLING DAMPER | 4 | |
| 6A | 370008 | SECOND SHAFT ASS'Y (A) | 1 | |
| 7 | 606ZZM | BALL BEARING 606VV | 1 | |
| 8 | 338921 | BEARING HOLDER | 1 | |
| 9 | 951039 | MACHINE SCREW (W/SP. WASHER) M4X12 | 3 | |
| 10 | 339257 | WASHER | 1 | |
| 11 | 338926 | RETURN SPRING | 1 | |
| 12 | 939548 | RETAINING RING FOR D22 SHAFT (10 PCS.) | 1 | |
| 13A | 376366 | WASHER (A) | 1 | |
| 14 | 338923 | SPINDLE GEAR SET | 1 | |
| 15 | 949203 | MACHINE SCREW M3X8 (10 PCS.) | 2 | |
| 16 | 338922 | BEARING COVER | 1 | |
| 17 | 6901VV | BALL BEARING 6901VV | 1 | |
| 18A | 338905 | LOWER GUARD | 1 | |
| 19 | 338927 | KNOB | 1 | |
| 20 | 302090 | TAPPING SCREW D4X10 (BLACK) | 1 | |
| 21 | 338935 | TCT SAW BLADE 165MM-D20 HOLE-NT24 | 1 | |
| 22A | 376367 | WASHER (B) | 1 | |
| 23 | 338917 | HEX. FLANGE BOLT | 1 | |
| 24A | 373653 | SAW COVER | 1 | |
| 25 | 333781 | MACHINE SCREW (W/WASHER) M4X12 (BLACK) | 1 | |
| 26 | 323211 | MACHINE SCREW M4X8 (BLACK) | 2 | |
| 27 | 339220 | LED | 1 | |
| *28 | 361011 | ROTOR ASS'Y | 1 | INCLUD. 106,107 TILL 5.2018 FOR AUS,NZL |
| *28A | 361078 | ROTOR (C) ASS'Y | 1 | INCLUD. 106,107 SINCE 6.2018 FOR AUS,NZL, MODEL (S) |
| 29 | 339374 | LED-CASE (C) | 1 | |
| 30 | 338918 | LOCK LEVER | 1 | |
| 31A | 371943 | LINK | 1 | SINCE 8.2017 |
| 32 | 339258 | GAUGE PLATE (A) | 1 | |
| 33 | 334225 | SPRING | 1 | |
| 34 | 307811 | TAPPING SCREW (W/FLANGE) D4X16 (BLACK) | 6 | |
| 35 | 319541 | SEAL LOCK HEX. SOCKET SET SCREW M5X6 | 3 | |
| 35 | 319541 | SEAL LOCK HEX. SOCKET SET SCREW M5X6 | 1 | TILL 10.2019 |
| 36 | 338907 | GEAR COVER | 1 | TILL 10.2019 |
| 36B | 376033 | GEAR COVER | 1 | SINCE 11.2019 |
| 37 | 310842 | CUSHION | 1 | |
| 38 | 949793 | FLAT HD. SCREW M5X20 (10 PCS.) | 1 | |
| 39 | 334242 | WAVE WASHER 8 | 1 | TILL 10.2019 |
| 40A | 371946 | COVER PLATE | 1 | TILL 10.2019 |
| 41A | 377291 | NYLON NUT M5 | 2 | |
| 41A | 377291 | NYLON NUT M5 | 1 | TILL 10.2019 |
| 42 | 338930 | LEVER (A) | 1 | TILL 10.2019 |
| 43A | 372219 | SEAL LOCK SCREW (W/SP. WASHER) M4 | 1 | TILL 10.2019 |
| 44 | 333681 | CAM | 1 | TILL 10.2019 |
| 45A | 371947 | PLATE | 1 | TILL 10.2019 |
| 46 | 338932 | LOCK SLEEVE | 1 | TILL 10.2019 |
| 47 | 333680 | CAM SHAFT | 1 | TILL 10.2019 |
| 47A | 375031 | BOLT (SQUARE) M6X20 | 1 | SINCE 11.2019 |

* ALTERNATIVE PARTS

HIKOKI

CIRCULAR SAW C6MEY

| Item No. | Code No. | Description | No. Used | Remarks |
|----------|----------|---|----------|--|
| 48 | 336650 | SPRING | 1 | |
| 49A | 374780 | KNOB | 1 | |
| 50 | 338899 | TRIGGER | 1 | |
| 51 | 307887 | MACHINE SCREW (W/WASHER) M3.5X6 | 2 | |
| 52A | 371322 | SWITCH | 1 | |
| 53 | 305691 | MACHINE SCREW (W/WASHERS) M4X14 (BLACK) | 1 | |
| *54 | 340913B | STATOR SENSOR PCB ASS'Y | 1 | TILL 5.2018 FOR AUS,NZL |
| *54A | 341042 | STATOR SENSOR PCB ASS'Y | 1 | SINCE 6.2018 FOR AUS,NZL,MODEL (S) |
| 55 | 959141 | CONNECTOR 50092 (10 PCS.) | 2 | |
| 56 | 937631 | CORD CLIP | 1 | |
| 57 | 984750 | TAPPING SCREW (W/FLANGE) D4X16 | 2 | |
| 58 | 953327 | CORD ARMOR D8.8 | 1 | |
| 59A | 371937 | HANDLE SET (GREEN) | 1 | |
| 60 | 334141 | MACHINE SCREW (W/WASHERS) M4X35 (BLACK) | 6 | |
| 61 | 338919 | FLOW GUIDE | 1 | |
| 62 | 338902 | HOUSING SET | 1 | |
| 63 | 336554 | CUSHION | 2 | |
| 64 | 338928 | RUBBER BUSHING | 1 | |
| 65 | 315500 | MACHINE SCREW (W/WASHER) M4X8 (BLACK) | 1 | |
| 66 | 338913 | GUIDE PIECE | 1 | |
| 67 | 942827 | RETAINING RING (E-TYPE) FOR D8 SHAFT | 1 | |
| 68 | 333660 | SPECIAL NUT M6 | 1 | |
| 69 | 333659 | CLAMP LEVER | 1 | |
| 70 | 949425 | WASHER M6 (10 PCS.) | 2 | |
| 71 | 317200 | MACHINE SCREW (W/WASHERS) M4X8 (BLACK) | 1 | |
| 72 | 333657 | STOPPER LEVER | 1 | |
| 73 | 339259 | SPRING (B) | 1 | |
| 74 | 307898 | WING BOLT M6X18 | 2 | |
| 75 | 324876 | SPRING | 2 | |
| 76A | 377288 | HEX. SOCKET SET SCREW M5X10 | 1 | |
| 77A | 371941 | BASE | 1 | |
| 78 | 301653 | TAPPING SCREW (W/FLANGE) D4X20 (BLACK) | 4 | |
| 79 | 301653 | TAPPING SCREW (W/FLANGE) D4X20 (BLACK) | 1 | |
| 80 | 338934 | SUB HANDLE | 1 | INCLUD.79 |
| 81 | | NAME PLATE | 1 | |
| 82 | 339260 | ADJUSTING SCREW (A) | 1 | |
| 83 | 305490 | TAPPING SCREW (W/FLANGE) D4X30 (BLACK) | 2 | |
| 84 | 320163 | STEP PIN D6X13 | 2 | |
| 85 | 314623 | BOLT (SQUARE) M6X22 | 1 | |
| 86 | 338910 | BEVEL PLATE | 1 | |
| 87A | 371944 | SUB LINK | 1 | SINCE 8.2017 |
| 88 | 333664 | SPECIAL BOLT | 1 | TILL 7.2017 |
| 88A | 371945 | SPECIAL SCREW | 1 | SINCE 8.2017 |
| 89 | 948167 | SUPER LOCK WASHER M6 | 1 | |
| 90A | 314623 | BOLT (SQUARE) M6X22 | 1 | |
| 91 | 338938 | CORD HOLDER | 1 | |
| *92 | 500247Z | CORD | 1 | (CORD ARMOR D8.8) |
| 93B | 371939 | BASE ASS'Y | 1 | INCLUD.31A,32,35,41A,65-77A,84-90A,104,108 |
| *94 | 375110 | WASHER | 1 | SINCE 6.2018 FOR AUS,NZL,MODEL (S) |
| 98 | 942827 | RETAINING RING (E-TYPE) FOR D8 SHAFT | 1 | SINCE 11.2019 |
| 99 | 374246 | LEVER | 1 | SINCE 11.2019 |
| 100 | 374248 | LOCK NUT | 1 | SINCE 11.2019 |

* ALTERNATIVE PARTS

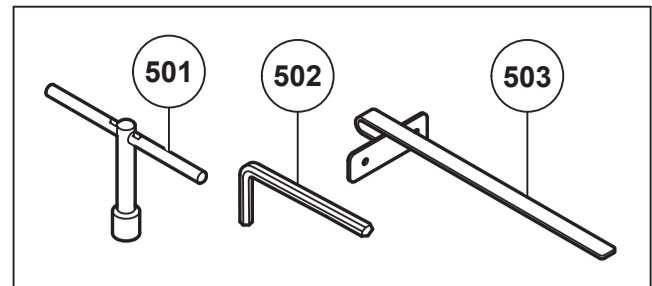

- 105A
- 36B 47A
- 98 ~ 104

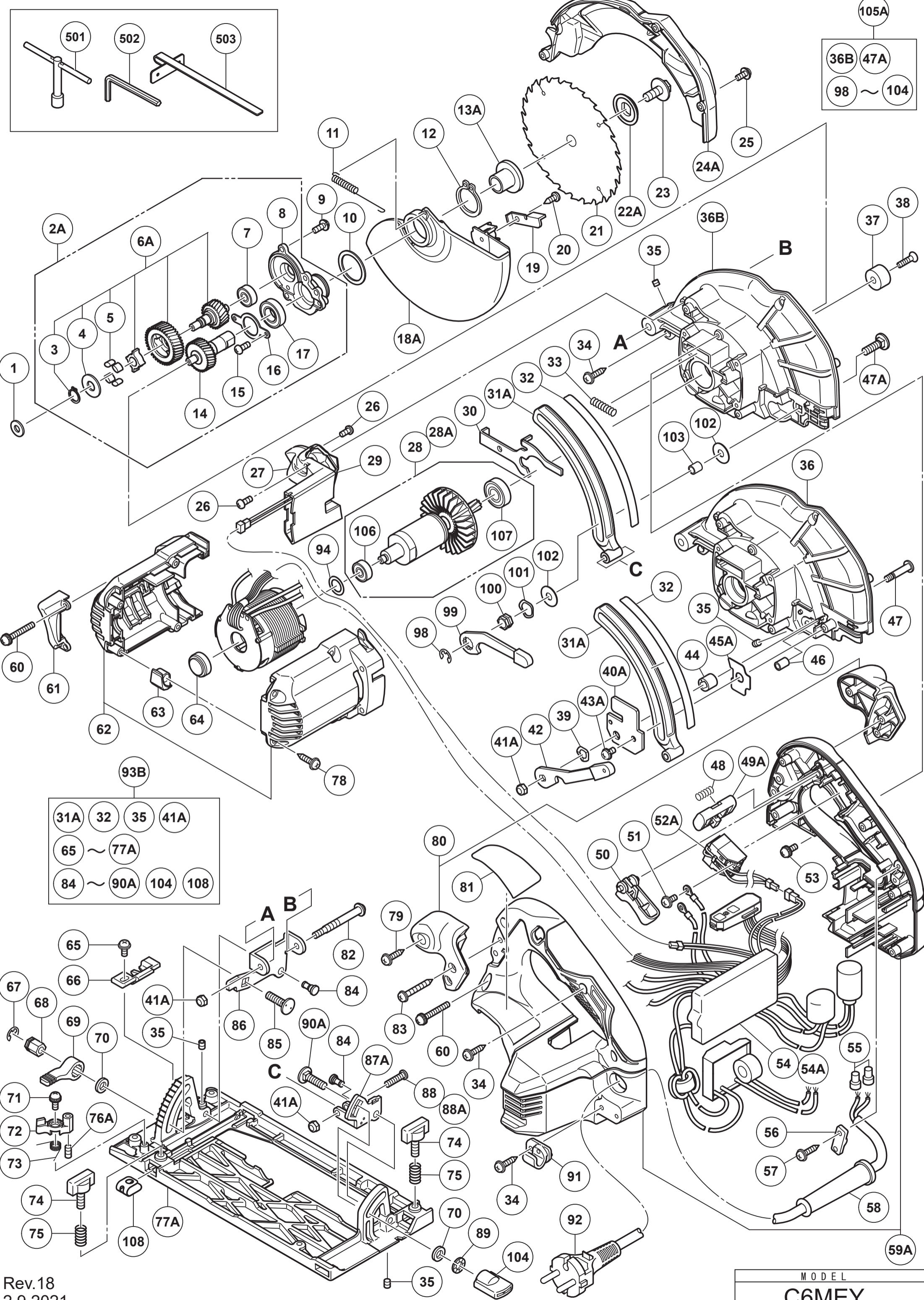

- 31A 32 35 41A
- 65 ~ 77A
- 84 ~ 90A 104 108

MODEL
C6MEY